

# WTC DSL Setup Instructions

This sheet will help you set up your WTC DSL kit. Before hooking anything up, please make sure you have a Network Interface Card (NIC) in your computer and have read these instructions.

## The Telephone Cord:

1. Plug one end of the phone cord into the DSL modem provided.
2. Plug the other end of the phone cord into the telephone jack in the wall.

### **DO NOT PLACE A FILTER BETWEEN THE DSL MODEM AND WALL JACK**

Avoid using extension phone cords and splitters if possible. Running the phone cord through a power bar can also cause problems.

## The Network Cable:

1. Plug one end of the network cable into the DSL modem.
2. Plug the other end of the network cable into the computer's network interface card (NIC),

Ensure you are using the cable that came with the DSL kit, or a cable of the same type.

## The Power Supply:

1. Plug one end of the power supply into the modem.
2. Plug the other end of the power supply into the power outlet in the wall, or into a power bar.

## The Filters:

1. For each telephone device: Plug the filter into the phone jack that will be used for your phone.

Ensure that all telephones, answering machines, fax machines, alarm systems and anything else that uses a phone jack, has a filter. If you have more phones than the number of filters supplied, extra filters are available for purchase from us.

### **VERY IMPORTANT: DO NOT FILTER THE DSL MODEM**

Leaving devices unfiltered may result in the loss of DSL signal.

**If you have any questions, you may contact Technical Support at:**

(613) 547-6939, option 2  
(513) 273-6939, option 2  
MSN: [support@kingston.net](mailto:support@kingston.net)  
Email: [Support@kingston.net](mailto:Support@kingston.net)

## Step 1 Install Line Filters

Devices such as fax machines, caller ID boxes, or phones that share the same phone number as your DSL account require a line filter, which prevents modem noise from disrupting the DSL signal on the phone line. Filters can be in the form of a stand-alone line filter or a wall mount filter. A filter can also be plugged into a two-to-one adapter if your DSL modem will share the same phone jack with another device.

### Stand-alone Line Filter

For each device that shares the DSL phone number:

1. Unplug the device's cord from the phone jack.
2. Plug the filter into the phone jack.
3. Plug the phone cord (or other device cord) into the filter.

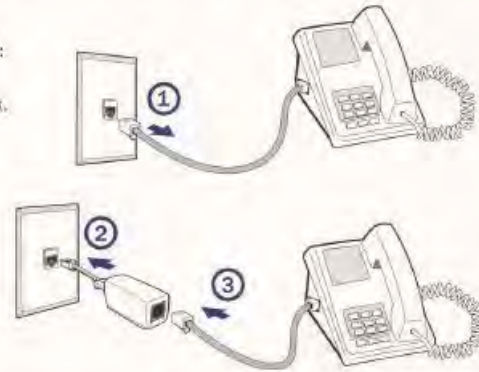

## Step 3 Connect the DSL Modem

1. With your computer off, connect the Ethernet Cable to the Ethernet port on the modem.
2. Connect the other end of the Ethernet cable to the Ethernet port on your computer.
3. Plug the DSL cable into the DSL port on the modem.
4. Plug the other end of the DSL cable into the phone jack.
- 4a. If using a two-to-one adapter, plug the cable into the open socket.
5. Plug the power adapter into the power outlet and modem.

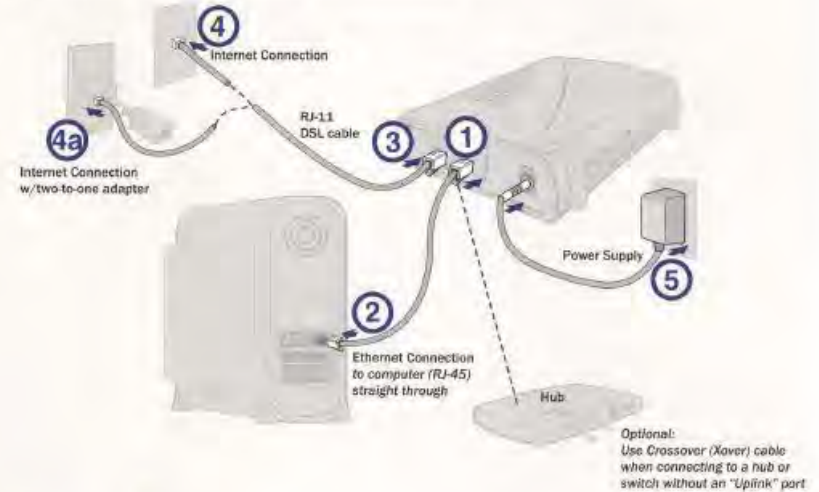

## Step 2 Install the Ethernet Adapter

You will need to install an Ethernet adapter if your computer does not already have one installed. Refer to your Ethernet adapter manufacturer's documentation for complete installation instructions.



## Step 4 Connect to the Internet

Congratulations, you have successfully completed the installation of your SpeedStream<sup>®</sup> Ethernet DSL modem. There is no modem software installation required. Simply power on the modem and the computer. Refer to your Internet Service provider's instructions for installing their software and/or connecting to the Internet.